



BATHURST MEMORIAL
ENTERTAINMENT CENTRE

CITY HALL

TECH SPECS

A bit about our venue

The Bathurst Memorial Entertainment Centre operates two performance venues. The Ian Macintosh Theatre seats 642 (391 in the stalls and 251 dress circle) and our City Hall is licensed to hold 1100 people.

This venue also has large conference rooms with partition walls that make four individual conference rooms for hire.

City Hall is more suited to cabaret style events, and is used quite regularly for balls, presentations, trade shows, dance party's etc. The venue also offers two foyers, one on ground level and another on the first floor "Wattle Foyer". There is a bar in each foyer and a third in the City Hall Auditorium.



City Hall - Auditorium



Flat floor auditorium with a mezzanine level. Two conference rooms at rear of ground level and two conference rooms on mezzanine level can be created by operable walls. Seating is set up of individual chairs.

Stage



Unraked stage with proscenium arch and no fly system. Concrete slab under the floor boards, covered in weathertex sheets. Screwing into the stage is permitted but larger holes need to be authorised by venue technician or operations manager. There is a narrow crossover of 500mm behind cyclorama.

Stage Dimensions

Proscenium Arch W 9346 mm H 3916 mm

Setting Line is the upstage edge of proscenium Arch

Distance From (SL = Setting Line, CL = Centre Line)

SL to DS edge of apron 1555 mm (no stage extensions) 2710 mm (with stage extensions)

SL to first lighting bar 850 mm

SL to centre lighting bar 3250 mm

SL to last lighting bar 5300 mm

SL to rear wall 6445 mm

CL to OP wall (or obstruction) 4700 mm

CL to PS wall (or obstruction) 5073 mm

Stage to underside of roof 4685 mm

Point loads for each lighting bar is 45 kgs per meter

Overhead Obstructions

Motorised screen 4000 mm. Fixed lighting bar (1) 4225 mm

Fixed lighting bar (2) 4245 mm. Fixed lighting bar (3) 4460 mm

Stage Drapery

*Type	Material	Colour	Width	Height	Quantity
House Curtain	Wool French action	Deep Purple	10000 mm	4300 mm	1
Mid Stage Tabs	Wool French action	Black	9400 mm	4700 mm	1
Borders	Wool	Black	9200 mm	1500 mm	2
Legs	Wool	Black	2000 mm	4800 mm	5
Cyclorama	Cotton / shark tooth	White	9400 mm	4900 mm	1
Smother	Wool French action	Black	10000 mm	4800 mm	1

Hanging Plot

Line #	setting line	Line Type	W.L.L	Venue Allocation
1	50 mm	Fixed		House Curtain
2	250 mm	Fixed		Motorised screen
3	850 mm	Fixed	315 kg	LX 1
4	1300 mm	Fixed		Border 1
5	1800 mm	Fixed		Leg 1 on stage edge
6	2600 mm	Fixed		Border 2
7	2850 mm	Fixed		Mid Stage tabs
8	3250 mm	Fixed	315 kg	LX 2
9	3550 mm	Fixed		Leg 2 on stage edge
10	5200 mm	Fixed		Leg 3 on stage edge
11	5300 mm	Fixed	405 kg	LX 3
12	5750 mm	Fixed		Smother
13	5850 mm	Fixed		Cyclorama

Access & Stage Equipment

EWP JLG AM30 DC Battery operated (Push Around) vertical lift
Platform Reach is 10.97 meters working height

Ladders (1) 6ft step ladder (1) 3m step ladder (1) Branch 3 meter platform push around
* There are one more of each of these ladders located in our other venue, if you require the use of these please contact in advance

Rostra 20 x 2000x1000mm stage rostra 600mm adjustable height

Loading Dock



Dock Access

Access is via court House Lane off Russell Street between Court House & Council chambers

Loading Dock Height is at street level

Door Dimensions Height 3100 mm width 3720 mm

Staging Notes

Dressing room access to stage is via OP side of stage. There is a small crossover behind cyclorama 500 mm wide.

A limited amount of rigging equipment is available in house. For rigging of larger shows or specialised pieces, own rigging equipment is required.

All materials must be fireproofed for stage use

All rigged items must be rigged with rated equipment, and must be approved by a venue representative

Lighting

Lighting rig plans can be found at bmec.com.au/venue-hire

Positions

Three onstage Lighting bars which are fixed. See hanging plot for standard LX bar locations

Booms

(6) x 4 metre & (2) x 2.5 metre booms available. (50mm round pipe with square base)

FOH Motorised truss 300 mm box truss 10 meters wide and 6 meters deep with two cross sections on 4-way motor controller

Setting Line to front of truss 5965 mm Usable bar width 10000mm

Mezzanine level any position on the handrail see floor plan

Control

Lighting desk Strand ML-250 Lighting Console

Control channels 250 conventional +30 intelligent with 24 x 6 pages of programmable faders

Signal output DMX

Signal distribution Ethernet and DMX stage OP and centre of mezzanine

DMX and Ethernet patch to all lighting bars, mezzanine handrails and FOH box truss

Dimmers

Dimmer location is downstage OP 2.4Kw Dimmer Racks x 3

JANDS FP-12 (2)

JANDS HP-2 (1)

Total dimmers @ 2.4kw per dimmer 36

House Lights

Independent control or at lighting desk

Control positions

Mix position at room centre or Mezzanine centre and upstage OP

Lamp List

Make	Model	Angle	Detail / Accessories	Watt	Total
Selecon	PL1 LED Profile	18/34	FOH BAR	120	6
Selecon	PL 1 LED Fresnel	Flood	Stage LX 1 / LX 3	120	9
Selecon	PL 3	Flood	Back light LX 3	460	3
Selecon	Acclaim	18/34	Lectern specials / FOH BAR	650	2

Lamp List (Available)

Profile

Make	Model	Angle	Detail / Accessories	Watt	Total
Selecon	Pacific	14/35	29 B size Gobo holders 1 Fergo holder & 2 iris's	1200	24
Selecon	Pacific	26/50		1200	6
Selecon	Acclaim	18/34	5 B size Gobo holders	650	10
Selecon	Acclaim	24/44		650	10
Strand	Brio	25/50	8 B size Gobo Holders	600	12
Strand	Brio	18/30		600	11
ETC	Source four jnr	25/50		575	8

Fresnel

Make	Model	Detail / Accessories	Watt	Total
Selecon	Arena	barn doors	2000	24
Selecon	Acclaim	barn doors	1200	14
Strand	Cantata	barn doors	1200	10
Selecon	Rama	barn doors	1200	8
Selecon	Acclaim	barn doors	650	12
Strand	Quartet	barn doors (3)	650	4

PC

Make	Model	Detail / Accessories	Watt	Total
ProLite	PC	barn doors (9)	650	8

Par Cans

Make	Model	Angle	Detail / Accessories	Watt	Total
Pro Shop	Multi-par 18		LED RGBW	180	20
Par Spots	Par64	MFL		1000	18

Flood

Make	Model	Detail / Accessories	Watt	Total
Prolite	CYC Unites	(4) cells per unit	500	4
Selecon	HUI	(4) cells per unit	500	6

Follow Spots

Make	Model	Angle	Detail / Accessories	Watt	Total
Prolite			Six colour Magazine	2000	2

Additional Lighting

Item	Make	Model	Detail / Accessories	Watt	Total
Moving light	Martin Mac	250 Krypton	Profile	250	2
UV Cannon		BL-UV400		400	4
Sconce Lamps				25	25

Patching

Location	Quantity	Numbering (PS to OP)	Detail / Accessories
FOH Truss	24	1-24	4 x 6-way looms
Mezzanine	14	1-14	GPO style patch points on mezzanine wall
Mezzanine	2	GPO	2 x 20-amp circuits for LED around mezzanine
LX 1	8	17-24	
LX 2	8	25-32	
LX 3	12	LX 3 Loom 1 & 2	2 x 6-way looms

Power

3 Phase Outlets

40 amps x 4 on stage

32 amps x 2 on stage

Cabling

The venue has many extension cables of various lengths for use by hirer. Any specific cabling requirements should be discussed prior to bump in.

Looms:

(3) 15m 6-way Weiland

(1) 20m 6-way Weiland

Audio

Control Position

Mix position is at centre of room or at stage OP

Sound Consoles

(Yamaha QL1 16 channel) main console

(Mackie Onyx 1640) 16 channels, 4 groups, 6 aux sends (firewire option) individual phantom power.

(Mackie Onyx 1220) 4 mic inputs, 4 stereo inputs, 2 aux sends (Yamaha QL5 32 channel)

(Yamaha MG16XU) 16 channel, 10 mic / 16 line inputs, 4 group, 4 aux including FX

(Yamaha MG20XU) 20 channel, 16 mic / 20 line inputs, 4 group, 4 aux including FX

Amplifiers

2x Crown K2 (Subs) bridged 2 channel 1100 watt per channel @ 4 ohms

2x Jedia L1.5 stereo power amps (foldback)

5x Audio Telex AT 120 single channel 100-volt line system for free space rear of room delay

EQ / FX

(Digital FX from Yamaha QL1)

1x DBX 1231 (FOH)

2x DBX -231 (foldback)

1x Midiverb 4 FX

2x Lexicon MX200

Compression / limiter / gates / drive

3x DBX-266XI (Available on request)

2x DBX-166xs (Available on request)

Speakers

8x DB Audio DVA-T8 self-powered line array (4 per side)

4x Omega pro 18' 800-watt subs under stage extension

Foldback

4x Mackie C300 passive speakers (another 4 available on request)

Additional Speakers

6x FBT Jolly 5JA self-powered speakers

4x Martin EM15 twin 5-inch passive

4x DB Flexsys F8 self-powered 400 W PRG

Playback

<i>Item</i>	<i>Make</i>	<i>Model</i>	<i>Detail</i>	<i>Total</i>
CD Player	Kenwood	DP 2080	Single CD, one is located in City Hall, but can moved on request	2
CD Player	Denon	DN-4500	Dual MP3 / CD player	1
Cassette player	Sony	TC-WC475	Dual deck domestic	1
Cassette player	JVC	TD-W354	Dual deck domestic	1

Microphones (Wireless)

Make	Model	Detail / Accessories	Use	Total
Shure	ULXD4Q	Quad Channel Receiver	Lapels/Handhelds	2
Shure	ULXD4D	Dual channel Receiver	Lapels/Handhelds	3
Shure	ULXD1	Body pack	Belt Pack Transmitter	14
Shure	ULXD2B58	Beta 58 handheld radio mic	Vocals	8
Shure	ULXD2B87A	Beta 87A handheld radio mic	Vocal / instrument	3
Shure	DPA-4066	Tan headset microphone	vocal	4
Shure	MX153T/0-TQG	Tan headset microphone	vocal	12

Microphones

Make	Model	Detail / Accessories	Use	Total
Shure	SM57	Dynamic	Instrument	5
Shure	SM58	Microphone clips Inc.	Vocals	12
AKG	D770	Mic. clips Inc.	Instrument	8
Sennheiser	604	Drum mics	Instrument	8
Shure	Beta 52A	Kick drum mic	Instrument	1
Audio Technica	871	Require phantom	Floor mics	4
Audio Technica	853	Require phantom	Hanging mics	4
Peavey	VCM 2	Require phantom	Hanging mics	2
AKG	C1000	Condenser	Instrument	2
Rode	NT3	Condenser	Instrument	2
Rode	NT5	Condenser	Instrument	4
Rode	NTG 2	Shotgun	Instrument	2

Accessories

Item	Model	Detail / Accessories	Total
Microphone Stands	Banquet	Tripod	6
Microphone Stands	Tri base	Short with Boom arm	13
Microphone Stands	Tri base	Tall with Boom arm	20
Direct Input Boxes	DOD 275	Active Direct Injection Box	4
Direct Input Boxes	Legacy	Active Direct Injection Box	4
Direct Input Boxes	Sound King	Active Direct Injection Box	8
USB DI	ARX	Stereo balanced AXR outputs	1
Speaker Stands	Sound King	Tripod Adjustable Height	6

Line Patching

Location	Quantity	Numbering	Detail
Prompt DS	2	C & D	2 sends
OP DS	2	A & B	2 sends
OP MS	32	1-24 / 1-8	24 sends, 8 returns

Speaker Patching

Location	Quantity	Numbering	Detail
Prompt DS	2	2 & 4	Foldback wall mounted speakon
OP DS	2	1 & 3	Foldback wall mounted speakon
OP MS	6	1-6	FOH

Audio Cabling

City Hall has a reasonable stock of leads for most audio applications within the venue.

2x 30-meter 8 way drop box

1x 30-meter 16 way drop box

1x 20-meter 8 way drop box

Audio Notes

FOH speaker's position is fixed

Effects and compression can be patched and un-patched for arrival on request

Audio Visual

Projectors

Type	Model	Detail / Accessories	Total
Hitachi	CP-WU9410	1080P Native, 8500 lumens, ultra-short lens 8:1. & Standard lens	1
Sony	VPL-DX10	2500 ansi lumens	1
Sony	VPL-FX52	8000 ansi lumens wide & standard Lens	1
NEC	P401-W	4000 ansi lumens wide throw	1

Projection Screens

Motorised screen with twin white front & rear projection surface 3000 mm x 2000 mm fixed behind proscenium

Front & rear projection screen on wheels surface made from German diffusion cloth 3000 mm x 2000 mm

TV / Monitor

2 x Samsung LED 4K 75 inch

Vision Switchers

Datavideo SE500 4 channel analogue switcher

Kramer VP-747 8x2:3 ProScale™ In-CTRL™ Dual Scaler Seamless Switcher

Kramer VP-727A 8x2:3 In-CTRL™ Stereo Audio Matrix Switcher

Shinybow SV5544 4x4 composite switcher

AV Playback

Item	Model	Detail / Accessories	Total
LG DVD Player		Single DVD player	1
Phillips DVD Player		Single DVD player	1
Sony BLU-RAY	BDP-S470	Multi format HDMI 3D & USB input	1

Projector Rigging Points

Projector can be rigged off any lighting bar using a T-bar and 90-degree Scaff coupling.

Cabling

The venue has a range of BNC video cabling

1 x DVI over CAT5 Extender WUXGA (1920 x 1200) available 40-metre max

4 x VGA over CAT5 Extender (1280 x 1024) 150-metre max

Patching

Location	Quantity	Numbering	Detail
OP mid stage	2	24 & 25	BNC patch behind amplifiers
Mix position room centre	3	32,33 & 15	BNC patch on ceiling above centre column
Rear auditorium wall	3	16 - 19	Conference rooms 1 & 2
Mezzanine	4	26-29	Conference rooms 3 & 4

Audio Visual Notes

Projector cradle is specific to venue's projector; hirer will need to bring their own cradle if using another projector.

Backstage Communications

Stage Managers Desk

Up stage OP at stage mix position

There is no permanent stage managers console. This can be a basic table with paging facilities and desk lamp etc.

Talkback

Master Unit Jands Talkback system running from sound desk

Wireless ClearCom DX210 x 4 transmitters (available on request)

8x sub stations

8x headsets

4x Radio Units

Talkback Patching

OP stage mix position and via multicore feed when at centre mix position

Paging / Show Relay

Paging to dressing rooms available at stage managers OP mix position

Stage Monitors

Stage monitoring is available for a set up cost only. No permanent set up available as yet.

Camera and monitors can be placed at prompt and OP if required

Dressing Rooms



Dressing Room	Capacity	Toilets	Shower	Details
Dressing Room 1	20	(4)	Yes	Air conditioned -Disabled access
Dressing Room 2	5	(1)	Yes	Air conditioned
Dressing Room 3	20	(2)	Yes	(2) heater
Dressing Room 4	5	(1)	Yes	(1) heater
Dressing Room 5	6	(1)	Yes	(2) heater

Laundry / Wardrobe



Washing Machines 2 x Large Capacity Maytag Washing Machine

Dryers 2 x Large Capacity Speed Queen Dryer

Drying rooms Laundry with Drying Rail

Iron / ironing board 2 x Irons and 2 x Ironing Boards

Clothes racks Fixed drying rail in laundry

Green Room



Tea / Coffee and washing up facilities. Small fridge and microwave.
Stage monitoring via tannoy and video monitor.

Stage Door

Stage door is located at the back of the crossover in the car park of William Street.
Stage door is not to be left open or unattended. The technician on duty will unlock stage door keypad at arranged access time. Stage door keypad will then be locked after the show.

Stage door code will be given to each touring group for duration of stay.

DOTL alarm will sound if stage door is left open for more than 4 minutes.

ADDITIONAL FACILITIES & INFORMATION

Orchestral

- (1) Steinway Concert Piano available on request
 - (2) Yamaha upright pianos. One is at stage level, the other located in the orchestra pit.
 - (35) Music Stands with (25) Sconce lamps
- All Pianos require tuning before use. This must be negotiated well in advance.

Rehearsal Space

Conference Rooms and City Hall can be used as rehearsal spaces with prior notice dependant on current bookings. This may also incur a fee.

Space has carpet on concrete floor.

Sprung Dance Floor

City Hall has a Harlequin Sprung Dance Floor with Standfast Vinyl Surface occupying its entire floor area except for the conference room end of the room.



City Hall Ground Floor Plans

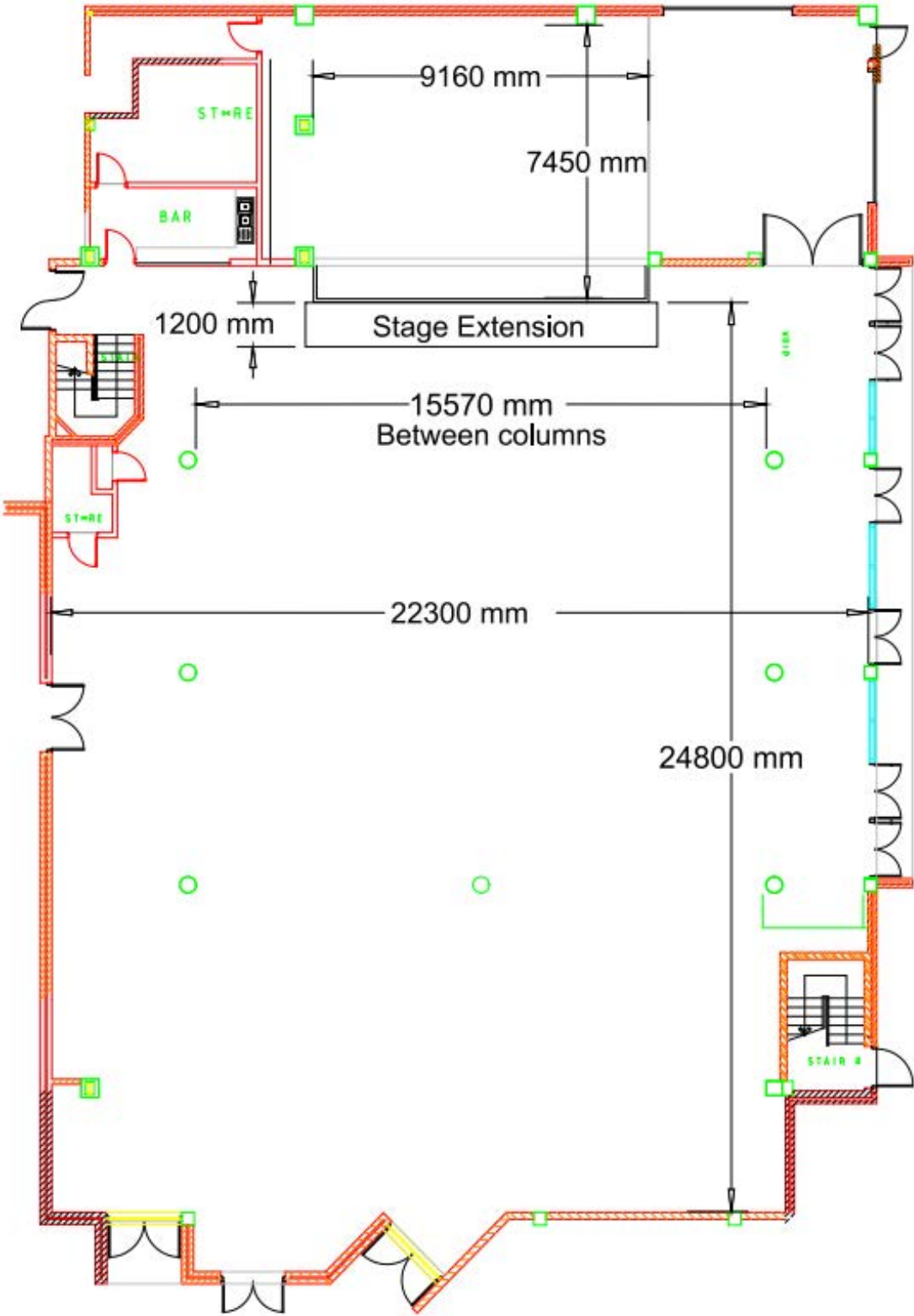

City Hall Mezzanine Plans

